

**ENG**



Instructions for use  
and setting of the module

Instructions for installation

## **Wi-Fi communication module GWD1**

---





# TABLE OF CONTENTS

Introduction.....	4
-------------------	---

## INSTRUCTIONS FOR USE AND SETTING OF THE MODULE

GWD1 module description.....	5
SeltronHome platform description .....	6
Setup communication module GWD1 .....	6
Setup connection with the controller.....	6
Download the Clausius mobile application .....	7
Create an account in Clausius .....	7
Register GWD1 on your user account.....	8
Connect GWD1 to a Wi-Fi network .....	9
Method A: Connect GWD1 to a Wi-Fi network with WPS button .....	9
Method B: Connect GWD1 to a Wi-Fi network with Clausius application .....	9
GWD1 connection with SeltronHome cloud service .....	11

## INSTRUCTIONS FOR INSTALLATION

GWD1 installation.....	12
GWD1 electrical connection .....	12
Supply voltage connection.....	13
Connection with a heating controller .....	13
COM fastener numbers on the controller for connection with a GWD .....	14
Minimum controller supported versions.....	14

## TROUBLESHOOTING, TECHNICAL DATA, STATEMENTS

GWD1 factory reset.....	15
Troubleshooting.....	15
Technical data.....	17
Declaration of conformity.....	18
Disposal of old electrical and electronic equipment.....	18
Notes .....	19

## Introduction

Wi-Fi communication modules GWD1 are advanced microprocessor-driven devices.

They are made with digital and SMT technology, intended for remote access to Seltron heating controllers with Clausius application.

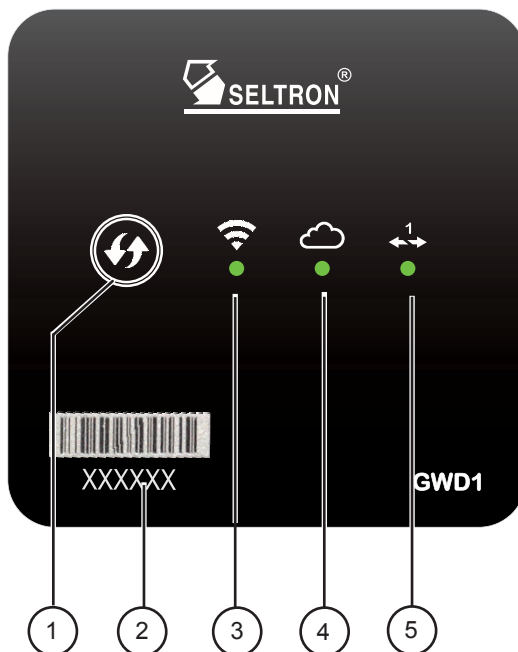

# INSTRUCTIONS FOR USE AND SETTING OF THE MODULE

## GWD1 module description



- 1 - WPS button for automatic connection with a wireless Wi-Fi network.
- 2 - Registration key of the GWD1 device.
- 3 - Signal light for the indication of connection to a Wi-Fi network.
- 4 - Signal light for the indication of connection to a cloud service.
- 5 - Signal light for the indication of connection to a Seltron heating controller.

Meaning of signal lights:

-  - signal light lights up in orange - connection is not established
-  - signal light flashes orange - connecting
-  - signal light lights up in green - connection is established

Occasional fast orange flashing, while the signal light lights in green, indicates communication, namely data transfer.

## SeltronHome platform description

Communication module GWD1 is connected to the heating controller via a wire (BUS) connection. The GWD1 connects in to the internet via the Wi-Fi router, through which it communicates with the SeltronHome cloud services.

SeltronHome service is a link between the communication with the mobile app Clausius. Clausius sends commands and data, obtained through SeltronHome services.

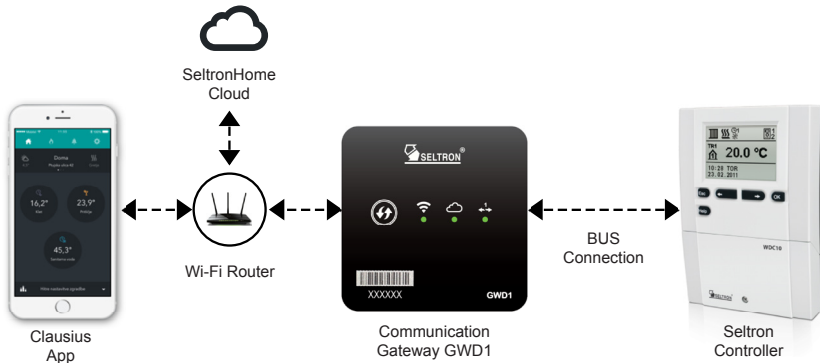

## Setup communication module GWD1

Before you start using the communication module GWD1 it is necessary:

- to mount the module on the wall,
- connect it to a Seltron controller,
- connect it to a supply voltage.

You can find technical instructions on pages 12 and 13.

**Electrical connection of the device must be carried out by a qualified installer or authorized organization.**

## Setup connection with the controller

Upon **connection to the supply voltage** (at first start or after a reset), the WPS button will light green and all signal lights will light **orange**.

Upon connection to the controller, the signal light for the controller  starts to flash orange.

Once the connection to the controller is established, signal light for the controller  will light green.



 If a connection with the controller can't be established please visit [www.seltronhome.com](http://www.seltronhome.com) and check if your controller is supported.

## Download the Clausius mobile application

Mobile application Clausius is used for the heating management and the connection of communication module GWD1 to the Internet.

For the devices with Android operating system you can find the application on Google Play. For the iOS devices you can find it on the App Store.

To find the application, write »SeltronHome« or »Clausius« into search engine field on Google Play or App Store. Application icon is illustrated on the right.

After the installation start the Clausius application.



Application Icon



*You can install Clausius application on smart devices with Android operating system 4.4 or higher and on iOS devices with operating system version 7.1 or higher.*



*The application can be used also on personal computers, laptops or unsupported smartphones via a web browser. To register and login in to the application in a web browser you must visit the web address <https://clausius.seltronhome.com>*

## Create an account in Clausius

To use the application you must first create the user account in the SeltronHome service.

For the registration you can use a valid and active Facebook or Google user account. In the registration procedure you will enter your user name and password, which you use in these services.

For the registration you can use also any other e-mail address that you possess. In this case you will have to enter a password, which you will use along with your e-mail address to login to SeltronHome Clausius application.

After the registration you will receive an e-mail with a web link, through which you will confirm your e-mail address.



*In the case that the Google and Facebook login page doesn't appear, check, if your web browser doesn't block the pop-up windows.*

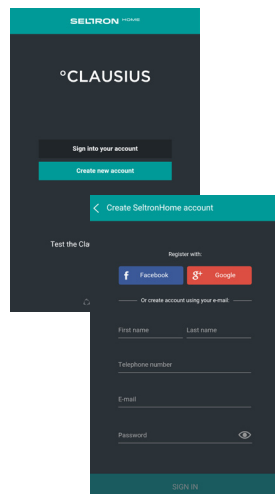

Choose an option »Create new account« and fill out the data

## Register GWD1 on your user account

- 1) Upon the first logging into the application, on the welcome screen choose the option »ADD YOUR NEW DEVICE AS OWNER«.
- 2) In the window for devices adding, enter the registration key of the GWD1 device and select »CHECK«.
- 3) Application checks and confirms if the registration key is correct. You have to repeat the process if you made a typing mistake.
- 4) In the window for building adding, you will enter the data for the building (apartment, house, company, street,...) in which the GWD1 is installed and select »CONTINUE«.

 Each GWD1 device has a unique registration key, which is printed on the front of the housing.

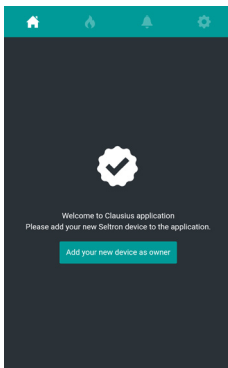

1) Tap the button »ADD YOUR NEW DEVICE AS OWNER«



2) Enter your registration key of the GWD1

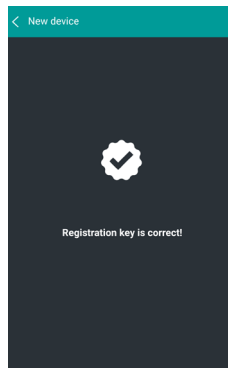

3) The application notifies you about properly inserted registration key

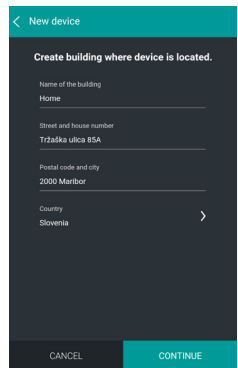

4) Fill out the data of your building.

After successful registration, connect the GWD1 into a wireless Wi-Fi network.

You can connect the GWD1 to your home Wi-Fi network in two ways:

- A: you can use the button WPS on the wireless router and on GWD1;
- B: you can use the application Seltron-Home Clausius on the smart phone, tablet PC or other PC;

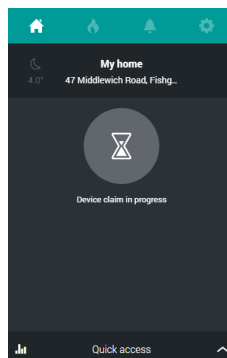

The application checks the status of the GWD1 connection

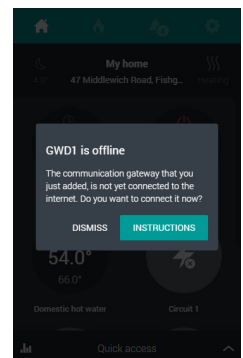

If the GWD1 is offline, on pop-window choose option »INSTRUCTIONS«



## Connect GWD1 to a Wi-Fi network

### Method A: Connect GWD1 to a Wi-Fi network with WPS button

If your Wi-Fi router is equipped with a **WPS** button (Wi-Fi Protected Setup), the wireless Wi-Fi connection can be set up easy, via this button.

*The WPS button on the wireless router, can be found under different names and acronyms. Some examples: QSS, QuickSetup, Push'n'Connect etc. If you don't find the WPS button on your wireless router, please check the instructions that came with your wireless router.*

### Connecting procedure

On the GWD1 press the WPS button , which will start to flash green. Within two minutes press the WPS button on your Wi-Fi router as well

After a few seconds, the WPS button is switched off and a wireless Wi-Fi connection starts establishing, which is indicated by orange flashing Wi-Fi signal light .

Once the wireless Wi-Fi connection to the Wi-Fi router is established, the Wi-Fi signal light  is lightning green.



### Method B: Connect GWD1 to a Wi-Fi network with Clausius application

**First leave the application and on your smart device open the settings for Wi-Fi networks.**

Among the available networks, find and select the network »GWD1-XX«. »XX« indicates the registration key's first two characters.

Your smart device or computer is now connected to the GWD1.

**Close the Wi-Fi settings, and return to the application SeltronHome Clausius.**

*At the first start or after reset the GWD1 is configured as an access point (an open network). This makes it possible for you to connect to GWD1 and complete its setup.*

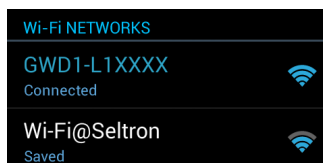

For the connection to GWD1 in the Wi-Fi settings choose Wi-Fi Network GWD1-XXXXXX

## Connecting procedure:

1. The application detects the GWD1 device. Tap »CONTINUE«.

*If the application after a few seconds doesn't detect the communication module GWD1, turn off the mobile data on your mobile device.*

2. Listed Wi-Fi networks, which are within the GWD1 range. Select your home Wi-Fi network.

*If the desired wireless network is not listed, select »REFRESH« and wait a few moments. GWD1 currently supports DHCP access.*

3. If the Wi-Fi network is secured with a password, you need to enter it to have the access to the selected network.

4. The application notifies you about completed configuration. Tap »CONTINUE«.

*If after completed configuration your mobile device or computer doesn't automatically establish an internet connection, manually switch back to your home wireless Wi-Fi network.*

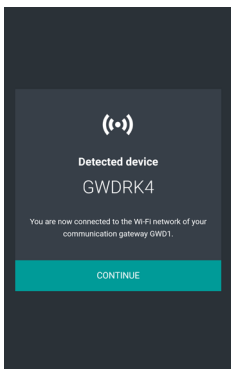

1. The application detects the device

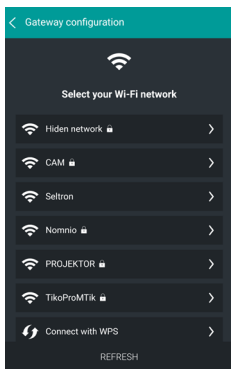

2. Choose your home Wi-Fi network from the list

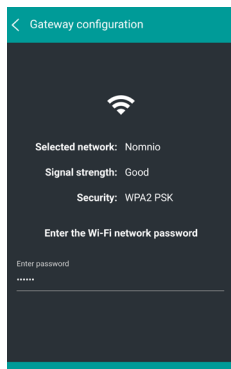

3. Enter the Wi-Fi password, if your network is secured with a password

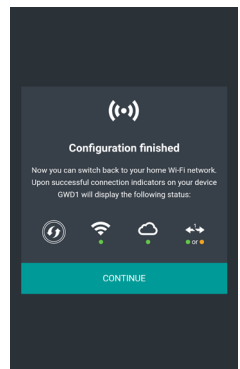

4. The application notifies you about completed configuration

## Condition of the signal lights on the GWD1 while connecting to Wi-Fi network

When the configuration is complete, the WPS button turns off, and establishing of wireless Wi-Fi connections starts, which is signaled with an orange flashing warning Wi-Fi light .



When the wireless connection is established with the Wi-Fi router, the signal Wi-Fi light  lights green.





If the connection is not established, the Wi-Fi signal light lights up in orange. Possible causes are as follows:

- 1) you entered the wrong password. In this case repeat the procedure (on page 9);
- 2) signal between the wireless router and GWD1 is too weak. Try to establish a better signal reception by moving the router or GWD1;
- 3) On the router you need to enable dynamic allocation of the IP (DHCP). Please consult with your Internet provider and check the instructions that came with your router.

### GWD1 connection with SeltronHome cloud service

After successful establishment of a wireless Wi-Fi connection, the GWD integration with »SeltronHome« service will be initiated automatically, which illustrates an orange flashing signal cloud light  .

Once the GWD1 connection is established with the service, signal cloud light  will light green.



If all three signal lights light green, the data connection, to operate GWD1, is successfully established.

# INSTRUCTIONS FOR INSTALLATION

## GWD1 installation

The GWD1 module must be installed in an indoor and dry area. Avoid immediate proximity of strong electromagnetic field sources. Choose the installation site so that the GWD1 is within the range of the Wi-Fi router's wireless network.

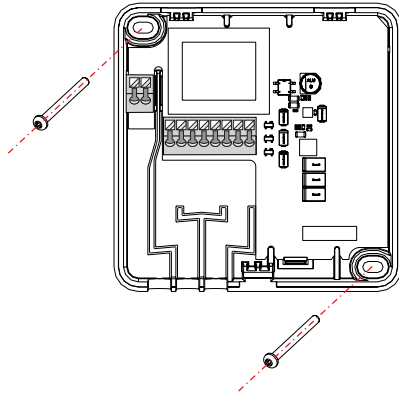

## GWD1 electrical connection



**Electrical connection of devices shall be done by a qualified technician or an authorised organisation.**

Prior to any intervention into the wiring, make sure that the main switch is switched off. Low voltage installation regulations IEC 60364 and VDE 0100, statutory provisions for accident prevention, statutory provisions for environmental protection and other national rules shall be observed.

Before you open the housing, make sure that **all poles of electrical supply had been disconnected.**

**Failure to follow these instructions can lead to serious injuries, such as burns or even threat to human life.**

## Supply voltage connection

Prior to connecting the supply voltage, you will need to open the module housing. Loosen the tab on the bottom side (1) with a flat screwdriver and open the housing on its bottom side (2). Cable of the mains power supply 230V must be connected to fasteners L and N and led along the dedicated channel out of the device housing (3).

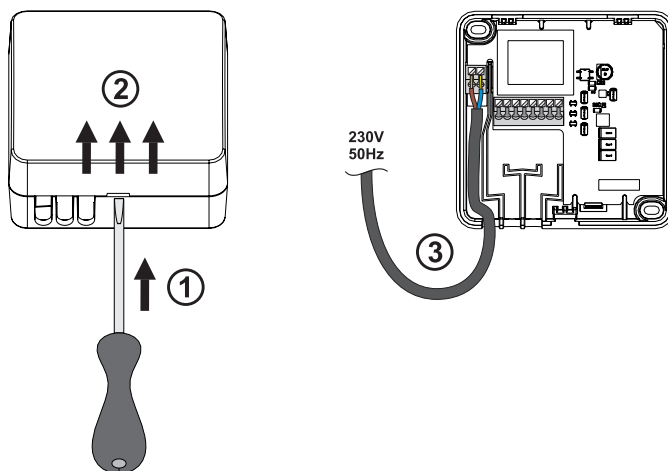

## Connection with a heating controller

Connect the GWD1 module to the WDC heating controller with a 2-wire cable. Connect the cable into fasteners 1 and 2 on GWD1 first, then connect it into COM and GND fasteners on the controller (4). See COM fastener numbers on the next page.

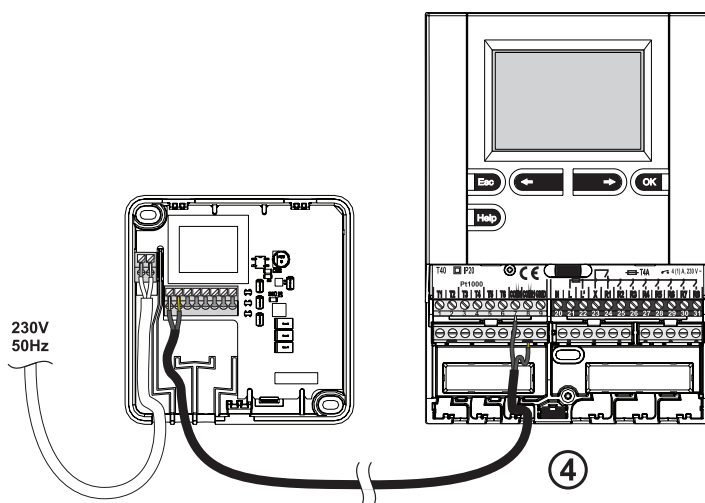

**COM fastener numbers on the controller for connection with a GWD**

---

PROMATIC WDC .....	7 and GND
PROMATIC WXD .....	12 and GND
PROMATIC SGC .....	7 and GND
PROMATIC KXD .....	13 and GND
PROMATIC KUD .....	13 and GND
PROMATIC KPD .....	13 and GND

**Minimum controller supported versions**

---

PROMATIC WDC .....	3.1r0
PROMATIC WXD .....	1.0r0
PROMATIC SGC .....	4.0.r0
PROMATIC SGC .....	3.1.r0 without flow measurement
PROMATIC KXD .....	1.0r0
PROMATIC KUD .....	1.0r0
PROMATIC KPD .....	1.3r0

## TROUBLESHOOTING, TECHNICAL DATA, STATEMENTS

### GWD1 factory reset

To reset the GWD1, please press down and hold the WPS button , until you hear a tone (for around 6 seconds).

### Troubleshooting

#### No signal light lights on the GWD1 module.

The GWD1 is not connected onto a power source or there is a blackout.

1. Check the electrical supply of the GWD1 module.
2. Assure that the power cord is connected correctly.

If the error still persists, contact your service technician for assistance.



#### The »Wi-Fi« and »cloud« signal lights on the GWD1 lights orange.

The GWD1 is not connected to the internet.

Possible errors are:

- changed password of the Wi-Fi networks;
- wireless router doesn't work or isn't connected to the electrical supply.

Via computer or smart device you can check the operation of the Wi-Fi router and internet connection. If the connection works flawlessly, you can again connect the GWD1 with the Wi-Fi router.



#### The »controller« signal light on the GWD1 lit in orange.

The WDC controller is not connected onto a power source or the connection to the controller has been disconnected.

Check the electrical supply of the WDC controller and wire line connection between the controller and the GWD1.



## The »cloud« signal light on the GWD1 lights orange.

*1. option: device is connected to the network but doesn't have access to internet.*



We recommend:

- reset your wireless router;
- reset your modem;
- check your internet connection access by you internet provider.

*2. option: the SeltronHome cloud services are currently under maintenance*

By update, the cloud services are under maintenance. Please wait until SeltronHome cloud services are again available and the GWD1 reconnects it self automatically with SeltronHome cloud services.

## The GWD1 WPS button lights green

*Settings of the communication module GWD1 have been reset.*

Please, connect the GWD1 to the internet again. Find these instructions on pages 9 and 10.



## All signal lights light green and the WPS button doesn't light

*If the service deosn't work and the lights on GWD1 indicate correct operation, there has been a malfunction of the GWD1.*

Disconnect the electrical supply from the GWD1 and reconnect it after 10 seconds. Wait until all light indicators stabilize and than check if the device works correct.



*If you didn't manage to resolve the problem after having tried the proposed solutions, please contact your contractor or let us know about it at [info@seltronhome.com](mailto:info@seltronhome.com).*



## Technical data

Dimensions [w x h x d]:.....	90 x 90 x 44 mm
Weight of the device.....	465 g
Device housing.....	PC - thermoplastic polycarbonate
Supply voltage.....	230 V ~ , 50 Hz
Own consumption.....	0.5 VA
Cross-sectional area of network conductors .....	0.5 to 0.75 mm <sup>2</sup>
Cross-sectional area of communication conductors..	0.25 to 0.33 mm <sup>2</sup>
Degree of protection .....	IP20 acc. to EN 60529
Safety class.....	II acc. to EN 60730-1
Permissible relative humidity.....	max. 85 % rH at 25°C
Temperature scope of use .....	+5°C to +40°C
Storage temperature .....	-20°C to +65°C
Program class .....	A

## Declaration of conformity

Wi-Fi communication modules GWD1 conform to the following directives:

- LVD: Low Voltage Directive 2014/35/EC,
- EMC: Electromagnetic Compatibility Directive 2014/30/EC,
- RoHS II: Directive on the restriction of the use of certain hazardous substances in electrical and electronic equipment 2002/95/EC.

### TYPE:

Wi-Fi communication module

### TIP:

GWD1

### STANDARDS USED:

EN 60730-1:2001, EN 60730-2-9:2002, EN 60730-2-11:2008



## Disposal of old electrical and electronic equipment

Disposal of old electrical and electronic equipment (applies to EU member states and other European countries with separate waste collection systems).



This symbol on the product or its packaging indicates that the product must not be disposed of in the household waste. It must be submitted at collection points for waste electrical and electronic equipment (WEEE). By disposing of this product in an appropriate manner, you will prevent the negative impacts onto the environment and health that might be caused by its inappropriate disposal.

Recycling of materials reduces the consumption of new raw materials. For more information on recycling of this product, contact the responsible authorities, public utility services or your retailer.





**SELTRON d.o.o.**

Tržaška cesta 85 A  
SI-2000 Maribor  
Slovenija

tel: +386 (0) 2 671 96 00  
fax: +386 (0) 2 671 96 66  
<http://www.seltron.si>  
email: [info@seltron.si](mailto:info@seltron.si)

V2.0